



ESTUDI RAMON FOLCH I ASSOCIATS, S.L.

Published on *ERF Energia i Sostenibilitat* (<https://www.erf.cat>)

## Sustainable adaptation of the Rydygiera residential development in Warsaw

Assistance to the architectural team in drawing up the executive project

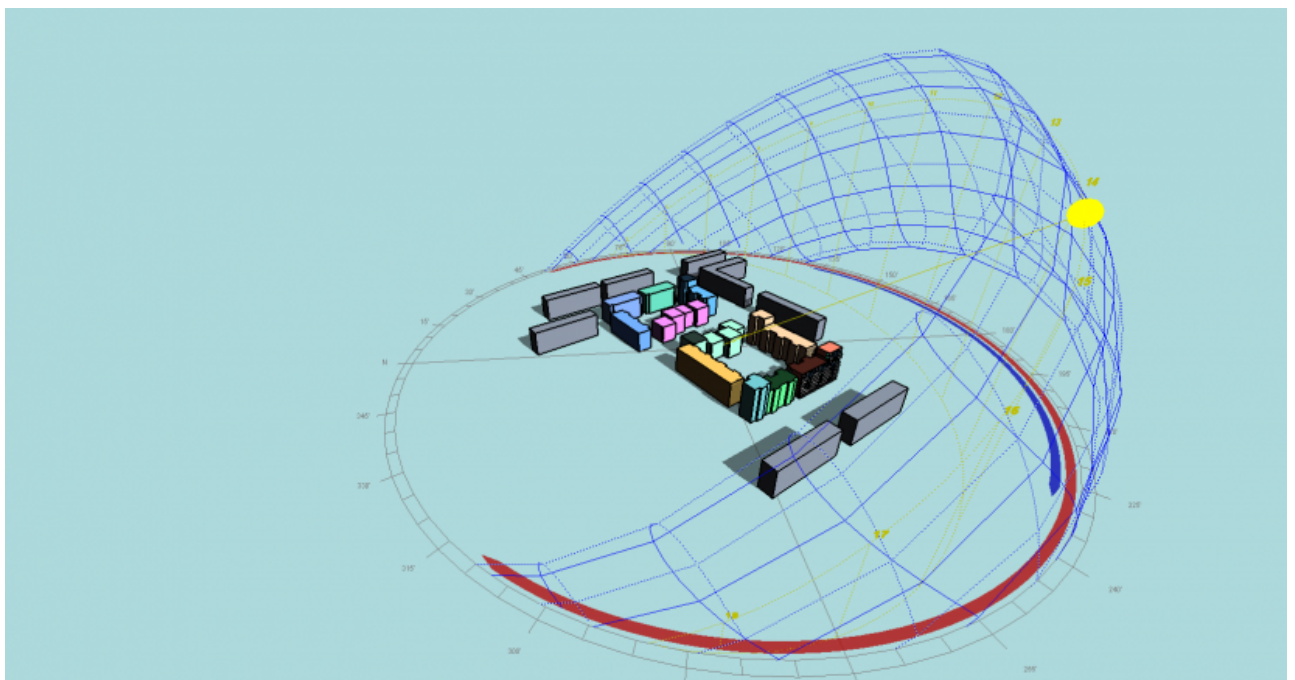

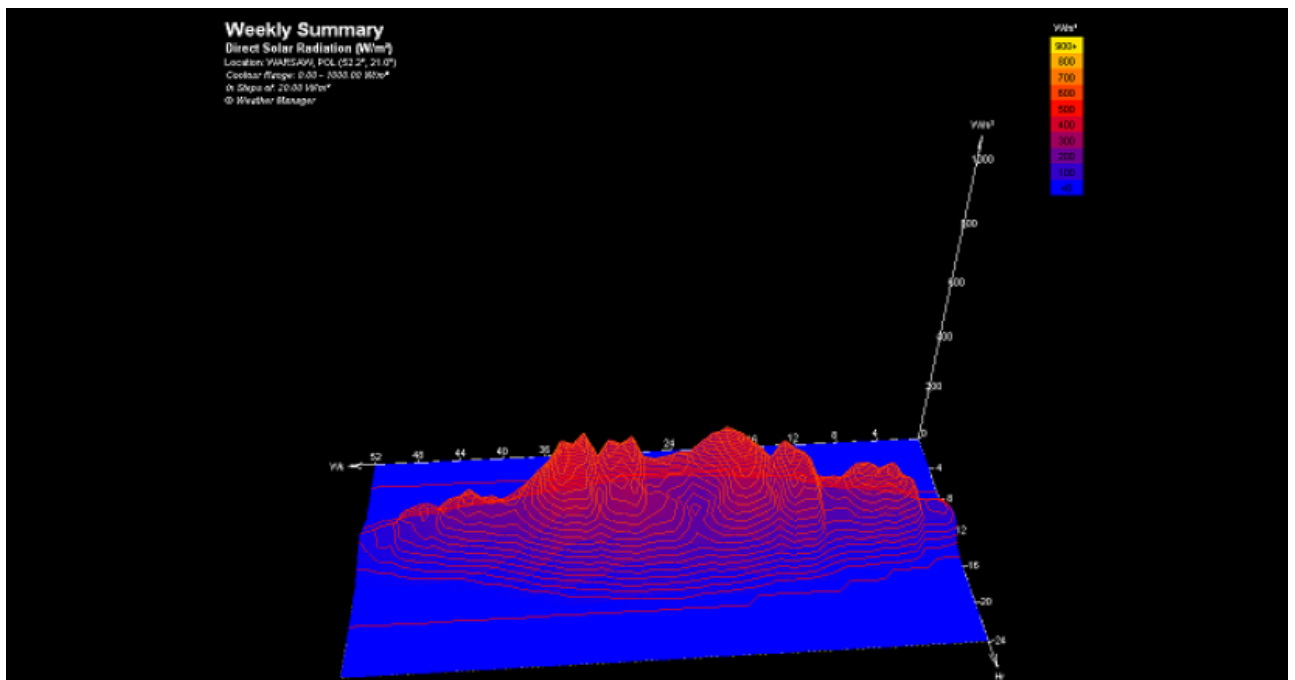

**Category:**

[Eficiència energètica](#) [1]

**Client**

Layetana Inmobiliaria

**Location**

Varsovia

**Period**

2010-2011

**Motivation**

Layetana Inmobiliaria S.A. developed the Rydygiera residential area in Warsaw (Poland). With a total area of 55,000 square metres, the development includes 700 apartments, as well as car parks and gardens. ERF worked on the first phase, which centred on the construction of 66 apartments, as well as car parks, gardens and a small business area on the ground floor, altogether a total of 5,600

square metres.

ERF's work ensured that the building met high quality standards in terms of sustainability and efficiency. As a result, energy, water and natural resource consumption and CO<sub>2</sub> emissions were all contained.

## Results

ERF drew up a quantitative report on the environmental and sustainability opportunities for the building. The different elements and sustainable alternatives applied generated a 35% reduction in final energy consumption compared to the building originally planned, with the environmental and economic savings that this entails.

### Categoria

[Eficiencia energètica a edificis nous](#) [2]

[Download pdf](#) [3]

---

**Source URL:** <https://www.erf.cat/en/projects/sustainable-adaptation-rydygiera-residential-development-warsaw>

### Links

[1] [https://www.erf.cat/en/projectes/?field\\_\\_mbit\\_tid=50](https://www.erf.cat/en/projectes/?field__mbit_tid=50)

[2] <https://www.erf.cat/en/categoria/edificaci%C3%B3-sostenible>

[3] <https://www.erf.cat/printpdf/473>